

PAD TYPES

"A"	- 26
"B"	- 19
"C"	- 8
Total Units	- 53

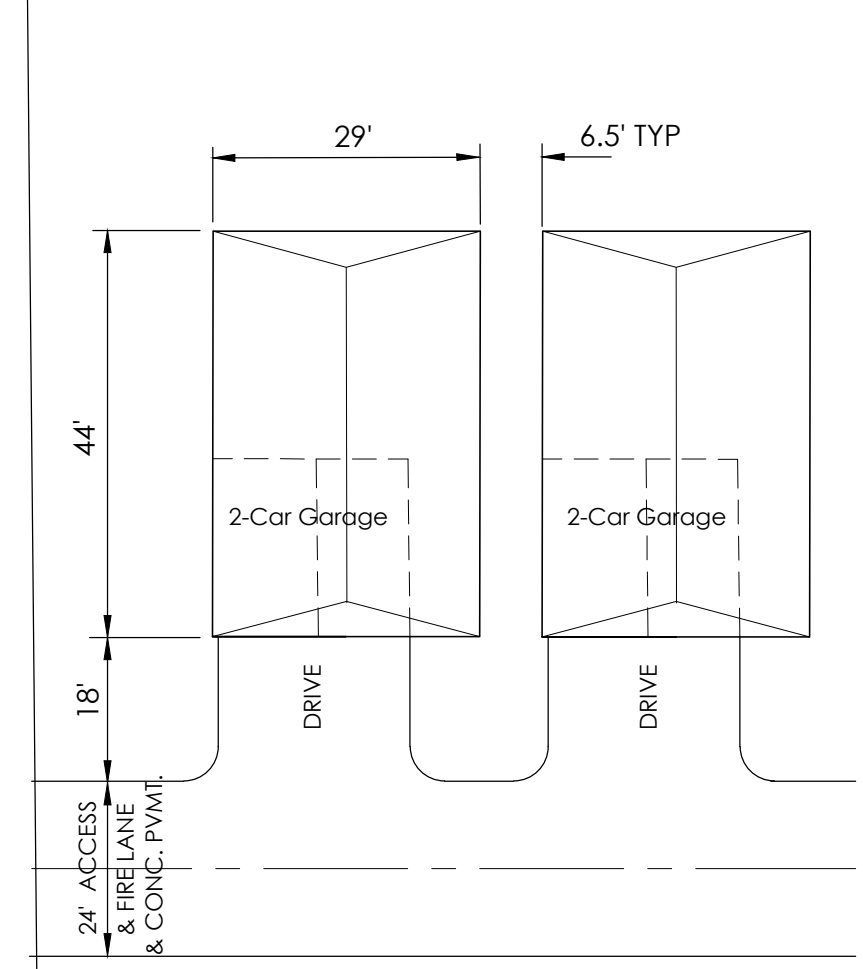

TYPICAL PAD DETAIL "A"

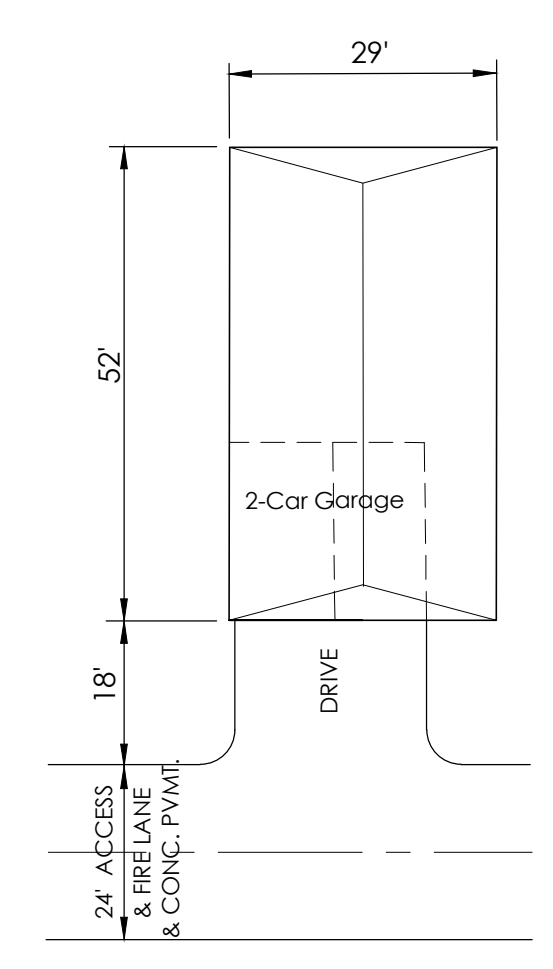

TYPICAL PAD DETAIL "B"

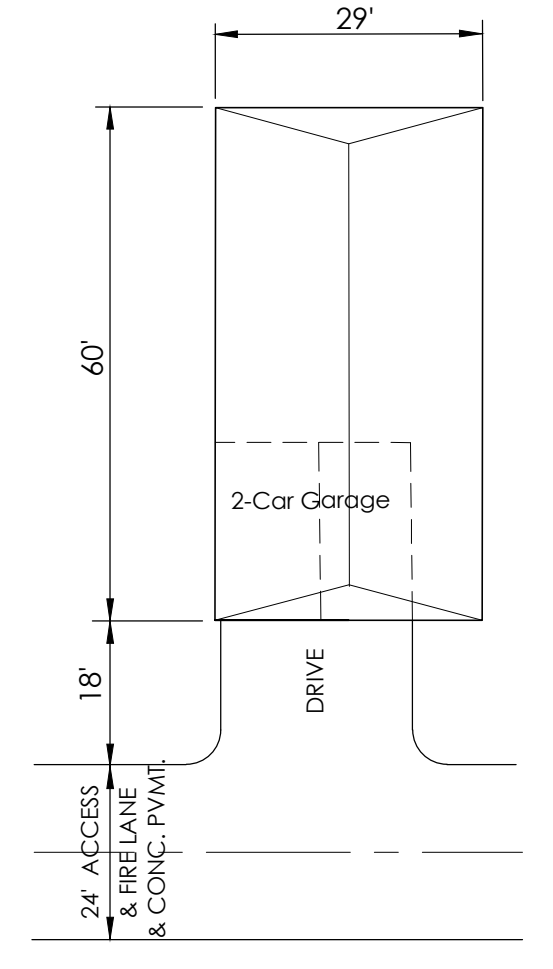

TYPICAL PAD DETAIL "C"

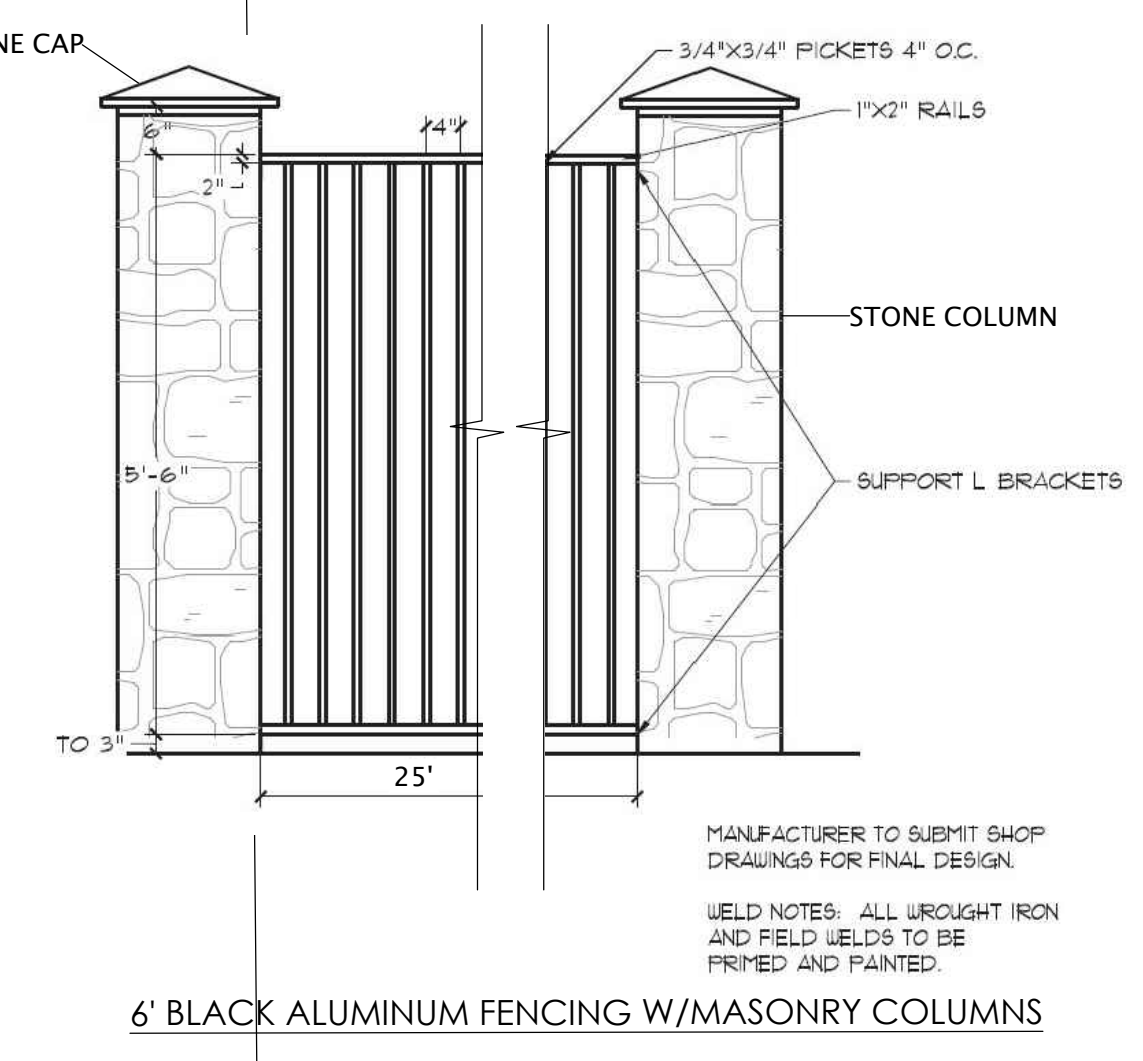

6' BLACK ALUMINUM FENCING W/MASONRY COLUMNS

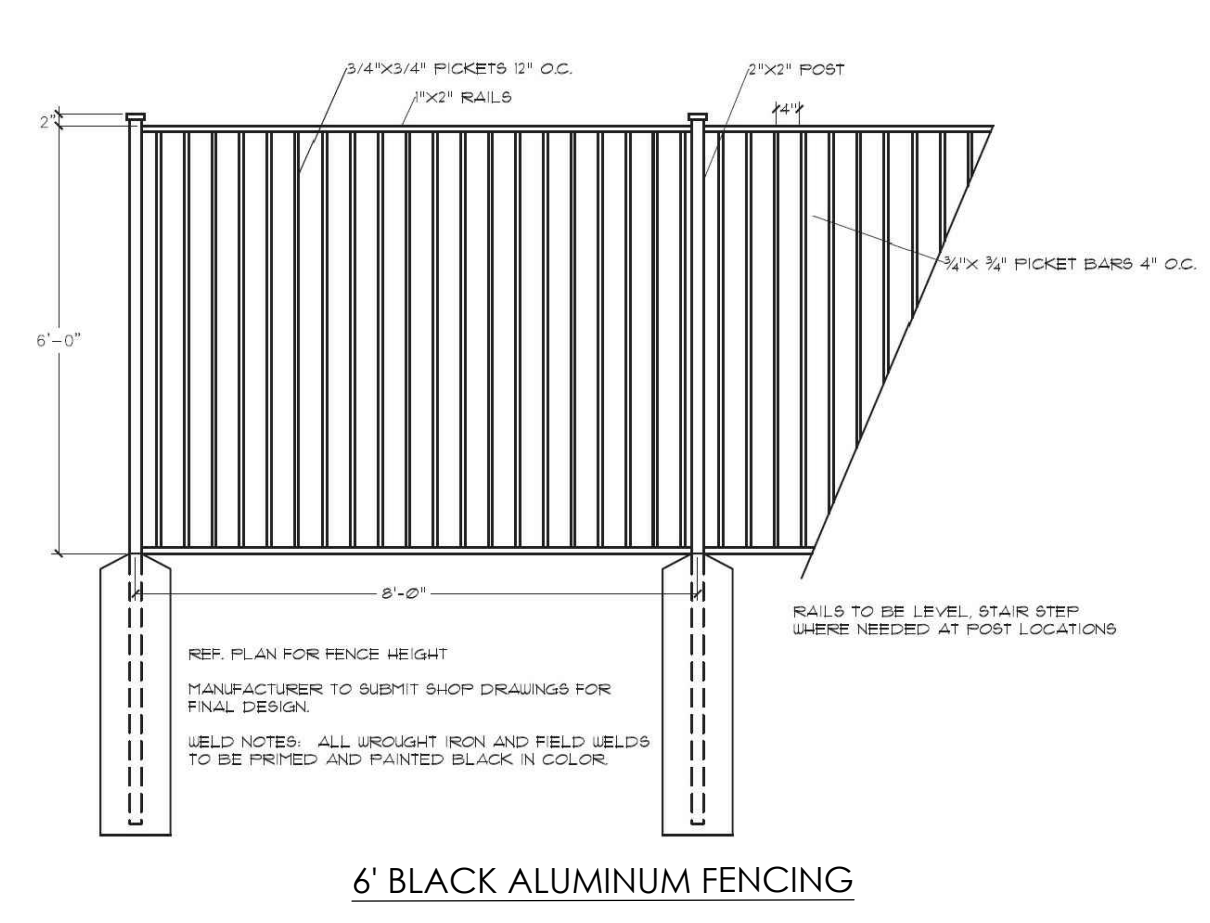

6' BLACK ALUMINUM FENCING

Ex. Zoning SF-20/Prop. Zoning PD-SF
 53 Units
 5.42 Ac. Net
 14.86 Ac. Gross
CONCEPT PLAN
Enclave at Maxwell Creek

Being a total of 14.86 Acres out of the Henry Maxwell Survey, Abst. No. 0579 City of Murphy, Collin County, Texas

OWNER:
ARCH FUNDING, LLC
 4407 Bee Caves Rd Ste 113
 West Lake Hills, TX
 78746-6498

CONSULTANT:
KPA consulting, inc.
 3076 Hays Lane
 Rockwall, Texas 75087
 972.388.6383
 kpatatkins@yahoo.com

DEVELOPER:
TACK TEAM INVESTMENTS LLC
 3930 Glade Rd. Suite 108-322
 Colleyville, Texas 76034
 469.688.8224 | 111tcci@att.net